

DuraPass
Side hinged garage doors

Insulated & Uninsulated Steel Side Hinged Garage Doors



U-Value 1.9 W/m²K (Insulated Door)

Great to come home to!



A style for every setting...

Insulated Linear Large in Anthracite Grey with 250mm x 1200mm windows



Insulated Flush in Golden oak with 500mm x 500mm windows



Insulated Linear Large in Anthracite Grey with 250mm x 1200mm window



Insulated Vertical Board in Anthracite Grey



Insulated Flush in Goosewing Grey with 250mm x 550mm windows

Effortless style

Take a look at our gallery of DuraPass doors installed around the country...

Note:

Doors shown with windows are insulated (windows are not available on uninsulated doors). Insulated doors feature stainless steel handles and hinges. Uninsulated doors feature black handles and hinges.



*Year Warranty FOR PERFORATION THROUGH FROM THE WEATHER SIDE DUE TO CORROSION ONLY.
 Year Warranty RESIDENTIAL USE
 Year Warranty COMMERCIAL USE

*Exclusions apply - see page 14

Insulated Vertical Board in Anthracite Grey



Uninsulated Vertical Board in Anthracite Grey

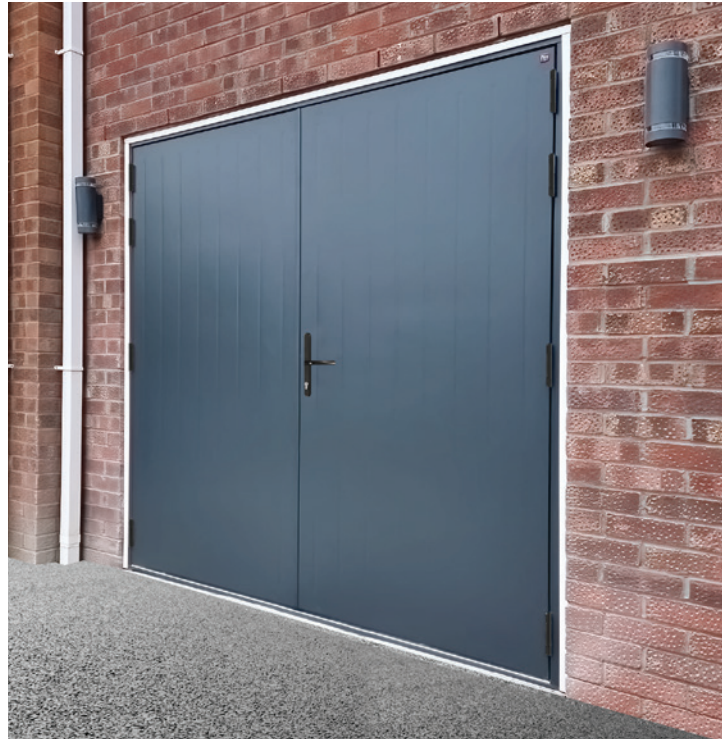

Insulated Linear Medium in Anthracite Grey



Uninsulated Vertical Board in White



Insulated Linear Medium in White



Insulated Vertical Board in Black

Insulated & Uninsulated Steel Garage Doors designed & built to the ideal requirements of your home

DuraPass doors are a brilliant solution for access to your garage - good looking, high performance garage doors and matching side doors.

Inspiring confidence & trust

- Manufactured in the UK.
- Fast turnaround and delivered throughout the UK & Ireland.
- CE marked, certified product.
- Innovation award winner with Patented design.
- **ERA** Multi-point locking:
 - Insulated doors have stainless steel handle and hinges.
 - Uninsulated doors have black handle and hinges.
- Available insulated or uninsulated.

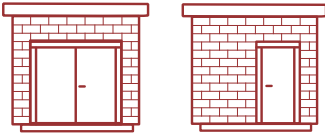

Linear Medium in Anthracite Grey



Vertical Board in Black



Linear Large in White



Contemporary Vertical in White



Flush* in Goosewing Grey

*NOT AVAILABLE UNINSULATED

Fully finished colours

Colour

Choose a finish from our standard or wood effect colour palettes:

Standard Colours



Wood Effect



10

*Year Warranty
FOR PERFORATION THROUGH
FROM THE WEATHER SIDE DUE TO
CORROSION ONLY.
*Exclusions apply -
see page 14

2

Year Warranty
RESIDENTIAL USE

1

Year Warranty
COMMERCIAL USE



***Golden Oak is recommended for Flush door designs only. The realistic wood effect finish will obscure the design elements on the face of the door.** Colours shown are for guide purposes only and are limited by the printing process. Always request to see a finish sample for confirmation of colour. RAL numbers are provided as the nearest approximation to the colour and will not match precisely.

Stainless steel is also available for something ultra-contemporary!



Flush in
Goosewing Grey

Linear Medium
in Anthracite

Contemporary Vertical
in White

Linear Large
in White

Vertical Board
in Black



Flush in
Golden Oak



U-Value 1.9 W/m²K

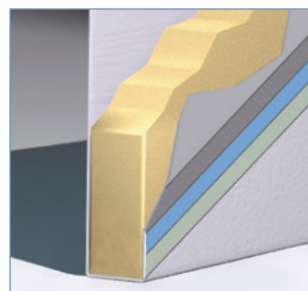

44mm Insulated doors

The 44mm Insulated panel on Insulated doors is made from exterior grade steel and is factory coated. It provides enhanced weather-beating performance - U-Value 1.9 W/m²K.

Feature file **insulated** double doors – So clever!

Many features of DuraPass **insulated** double leaf doors are shared with the single leaf door shown on pages 10 and 11. Below are additional and selected features.

Insulated double doors are available in a range of made to measure sizes with 50:50 split available on all sizes or asymmetric (off-centre), as shown right, available on selected sizes to allow convenient access on foot and for bikes and lawn mowers, etc.

- Available as open-out only.
- Multi-point locking as standard.
- Made-to-measure.



Secure **ERA**

10-point locking consists of 4-point ERA locking, including dead bolt, where the door leaves interlock, 2 shoot bolts and 4 security pinned hinges that extend through the frame.



Double door inactive leaf

Heavy duty spring-loaded shoot bolts secure the inactive leaf through the frame's top and bottom. The 4-point ERA system locks into the inactive leaf for dependable security.

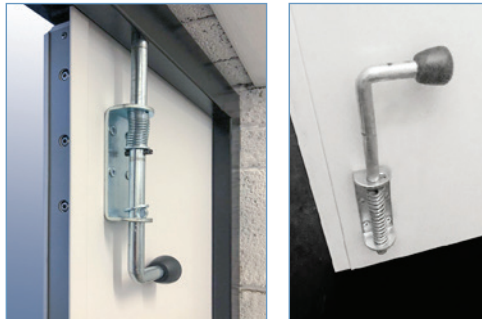

Anti-jemmy strip

The standard anti-jemmy strip conceals the ERA multi-point locking.



Heavy duty stainless steel handle and hinges

The door is operated by a stainless steel lever handle. Each door leaf has four heavy duty stainless steel hinges resulting in very smooth operation. The two top and bottom hinges include security pins as part of the 10-point locking system.



Made to
measure



All doors are made to measure!



10
LOCKING
POINTS



*Year Warranty FOR PERFORATION THROUGH FROM THE WEATHER SIDE DUE TO CORROSION ONLY.

*Exclusions apply - see page 14

Extra Easy



Stays as standard

Heavy duty door stays provide a positive lock-out, preventing the door from closing. A light pull on the release cord and your door is ready to close. **Note:** stays are not designed for high wind applications. Doors should not be left unattended on windy days as gusts may damage the door and stays. (Damage of this nature is not covered under warranty).



Extra Easy



Standard ramped threshold

The standard ramped threshold makes it easy to move items in or out and features an Exitex ramped seal that closes snugly against the bottom of the door leaf. The threshold is not suitable for vehicular or heavy wheeled item access.



Internal Thumb Turn

Doors are supplied with a thumb turn for easy, keyless exit from inside the garage.

Extra Easy



White on the inside

The rear face of the door panel on all standard colour and wood effect doors is finished in a soft-white light reflecting finish.

The frame will match the finish of the front face. Shown right is a Goosewing Grey door from the inside - White inner face, Goosewing Grey Frame.

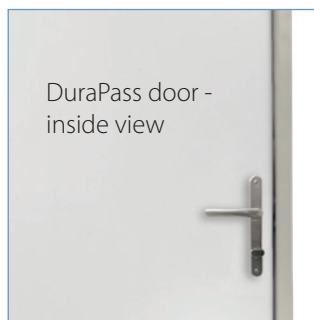

DuraPass door - inside view



All round weather seals

Genuine Q-Lon seals on the door frame and anti-jemmy strip help provide protection against water ingress*.

* Dependent on floor conditions. See P12 regarding the best performance for your door and in particular floor rebates.

Weather Shield



Feature file **uninsulated** double doors

Made to measure



Available made-to-measure!

Many features of DuraPass **uninsulated** double leaf doors are shared with the single leaf door shown on pages 10 and 11. Below are additional and selected features.

Uninsulated double doors are available in a range of standard sizes or made-to-measure with a 50:50 split.

- Available as open-out only.
- Multi-point locking as standard.
- Not available in the Flush door design.

Uninsulated double doors are available in the following standard sizes, (made to measure sizes also available):

Nominal	Over Frame
6'8.5" x 6'3"	2146 x 1971
7'0" x 6'4"	2234 x 1991
7'0" x 6'6"	2234 x 2041
7'0" x 7'0"	2234 x 2196
7'2.5" x 6'3"	2298 x 1971
7'2.5" x 6'6"	2300 x 2041



Interior reinforcement

Every uninsulated door has interior reinforcing bracing as standard. The bracing will match the colour of the exterior of the door.



Secure ERA

The locking consists of 4-point ERA locking, including dead bolt, where the door leaves interlock, and 2 shoot bolts.



Double door inactive leaf

Heavy duty spring-loaded shoot bolts secure the inactive leaf through the frame's top and bottom. The 4-point ERA system locks into the inactive leaf for dependable security.

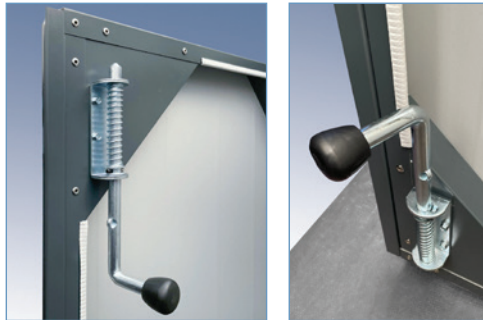

Anti-jemmy strip

The standard anti-jemmy strip conceals the ERA multi-point locking.



Heavy duty handle and hinges

The door is operated by a black lever handle. Each door leaf has four black steel hinges resulting in smooth operation.



6
LOCKING
POINTS



*Year Warranty FOR PERFORATION THROUGH FROM THE WEATHER SIDE DUE TO CORROSION ONLY.
*Exclusions apply - see page 14



Extra Easy

Stays as standard

Heavy duty door stays provide a positive lock-out, preventing the door from closing. A light push on the release and your door is ready to close. **Note:** stays are not designed for high wind applications. Doors should not be left unattended on windy days as gusts may damage the door and stays. (Damage of this nature is not covered under warranty).



Extra Easy



Standard rebated threshold

The standard rebated threshold incorporates genuine Q-Lon seals to help assist protection against ingress. The threshold is not suitable for vehicular or heavy wheeled item access.



Internal Thumb Turn

Doors are supplied with a thumb turn for easy, keyless exit from inside the garage.

Extra Easy

Mid-grey on the inside

The rear face of the door panel on all standard colour and wood effect doors is finished in a mid-grey light reflecting finish.

The frame and inside reinforcement bracing on uninsulated doors matches the finish of the front face of the door.

Shown right is a Black door from the inside - mid-grey inner face, Black frame and black interior reinforcing bracing.



DuraPass door - inside view



All round weather seals

Genuine Q-Lon seals on the door frame and anti-jemmy strip help provide protection against water ingress*.

* Dependent on floor conditions. See P12 regarding the best performance for your door and in particular floor rebates.

Weather Shield

Feature file **insulated** single doors – so innovative!

Dependable security

The dead bolt locking with twin hook latches and 4 security-pinned stainless-steel hinges per leaf provide robust, dependable security. 8-point locking is the result.

Stainless steel handle and hinges for durable, stylish security

The corrosion resistant stainless steel handle, lock, strike plate and hinges provide attractive and durably finished secure access.



3 keys as standard

Supplied with 3 keys and a Euro-profile cylinder as standard. Replacement keys can be duplicated from a standard blank at any locksmith.



Clever design

No rivets or welds to the front face of the door and colour matched frame as standard.



Low profile

The standard low-profile threshold with weatherseal makes it easy to move any wheeled item in or out. Open-in or open-out options. Thresholds available to meet the requirements of The Equality Act, Building regulations Part M and BS 3800.



Made to measure



All doors are made to measure!



8
LOCKING
POINTS



*Year Warranty FOR PERFORATION THROUGH FROM THE WEATHER SIDE DUE TO CORROSION ONLY.
RESIDENTIAL USE
COMMERCIAL USE

*Exclusions apply - see page 14

U-Value 1.9 W/m²K
Pre-framed doorsets



White on the inside
The rear face of the door panel on all standard colour and wood effect doors is finished in a soft-white light reflecting finish. The frame will match the finish of the front face. Shown above is a Goosewing Grey door from the inside - White inner face, Goosewing Grey Frame.

Designer Style

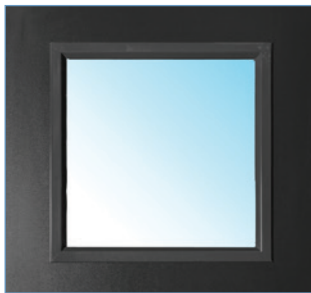

Let the light in
Vision panel window options can be configured in a variety of ways to suit your needs. See page 10 for design options.

Weather Shield



All round weather seals
Genuine Q-Lon seals on the door frame help provide protection against water ingress.

Weather Shield

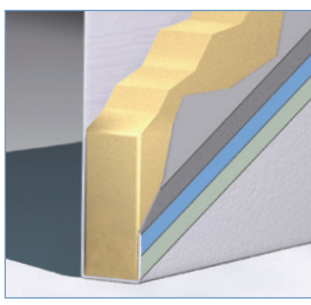

44mm Insulated doors
The 44mm Insulated panel on Insulated doors is made from exterior grade steel and is factory coated. It provides enhanced weather-beating performance - U-Value 1.9 W/m²K.

Built to Last



Extra strength
Doors are pre-framed with four stainless steel security-pinned hinges.



Weather Shield



Seal strip
Inward opening doors incorporate an excellent Exitex aluminium weather profile that the door closes onto, providing an effective inward opening weather barrier.*

*Inward opening doors provide an effective weather barrier in normal conditions. They are not, however, recommended in areas exposed to extreme weather conditions. High winds and rain may compromise the performance of this door type. In these situations, open out doors are recommended, which incorporate a rebate behind the door leaf.

Vision panels

insulated doors only!

Add vision and style!

Windows are available on **insulated doors only** and are shown in clear or frosted toughened safety glass (Glass ABS 6206: 1981).

NOTE: all windows are positioned at equal distances from the door leaf edges

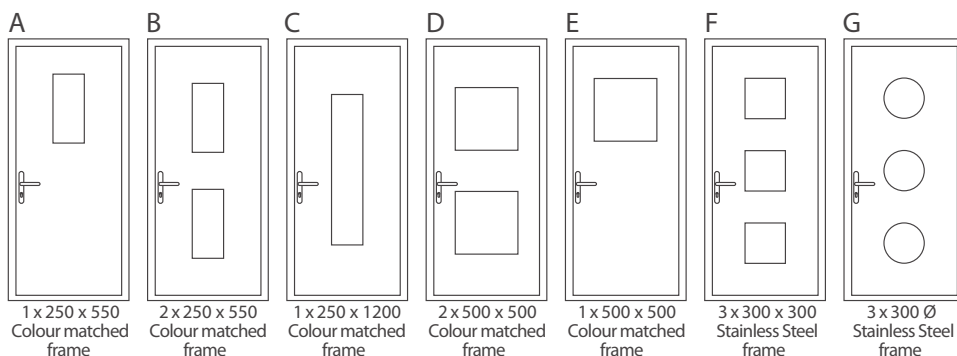

Choose from the configurations shown or contact GDS if you have an alternative requirement.

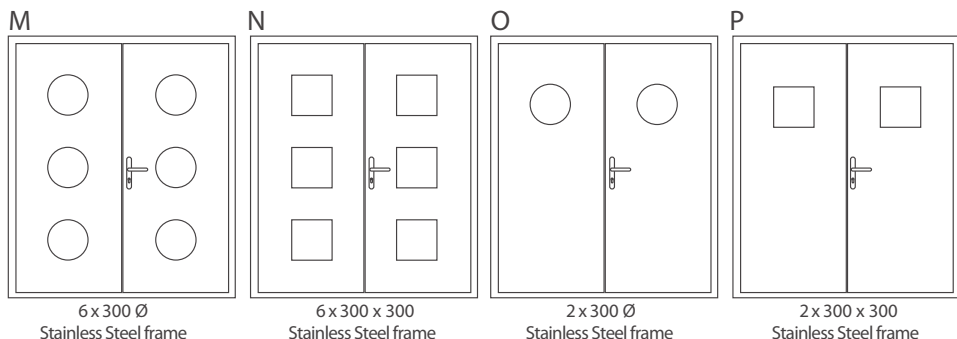
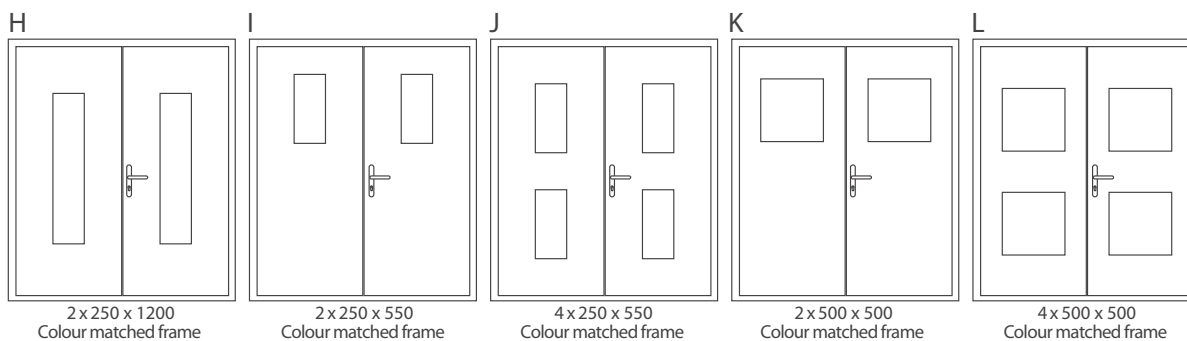

Window position

- Single 250mm x 1200mm windows are positioned centrally in the door leaf.
- Single 250mm x 550mm, 300mm x 300mm, 300Ø & 500mm x 500mm windows are positioned centrally in the top half of the door leaf.
- Double and triple windows are positioned centrally in the door leaf with equal vertical spacing between each window and the top and bottom of the door.

Personnel and Double Door Frames

The door frame provides a precise, neat and clean finish. The standard frame is versatile and quick to install with fixing slots for easy alignment. Double door frames are fully boxed for strength.



The clean lines of the frame profile



Double door frame edge



Personnel door frame edge



The best performance for your door

The Quality Check

This check is as the recommended standard from the Door & Hardware Federation (DHF). The quality check should be carried out in natural daylight, not direct sunlight. Stand at a distance of 3 metres from the door to view the overall appearance. The door is acceptable if, taking into account the facts below, none of the following is readily visible on the face of the door:

- marks or distortion associated with the manufacturing process
- minor indentations, marks or scuffs on the surface
- paint or stain blemishes

Opening arc

The area within the arc of the door's swing must be level or sloping down to ensure the door can open unhindered.

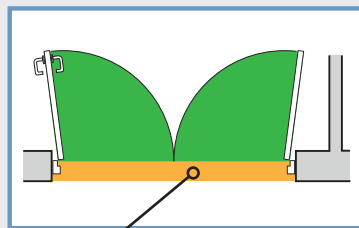

10mm rebate

Floor rebate

To help assist water draining away effectively from your door and prevent water ingress you must have a rebate (minimum 10mm) high behind the door threshold or where your door seal meets a level floor. If your floor is not rebated and not sloping down from the inner face of your door outwards, you will be susceptible to water ingress, as water will not be able to drain away effectively.

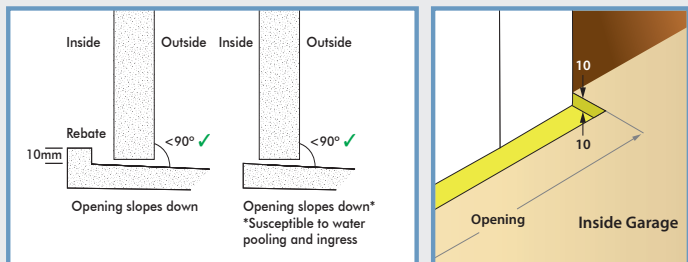

Warranty

1 year commercial use warranty / **2 year** residential use warranty on: door components, accessories, seals and thresholds.

10 year* warranty for perforation through from the weather side due to corrosion only.

*The door must be cleaned in accordance with the care and maintenance instructions.

At least 10% of the overall door surface area must be impacted. Chips, scratches, rubbing or scuffing, which result in cosmetic or surface corrosion, or natural fade or weathering (UV radiation and/or coastal conditions...etc) of the finished surface are not covered in this warranty.

The corrosion of swarf filings or other air borne particles, rusting or staining of the panel is not considered panel rust.

These are key parts of the full terms and conditions which are available in a complete form in the customer care booklet.

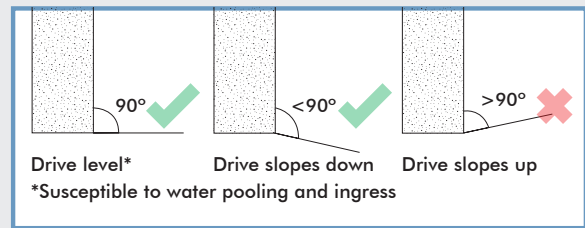

The door threshold

The threshold must be fitted level, failure to do so will impact performance. The threshold is not suitable for vehicular or heavy wheeled item access. This will distort the frame and rubber seal element.



Open in or open out?

Inward opening doors provide an effective weather barrier in normal conditions. They are not, however, recommended in areas exposed to extreme weather conditions. High winds and rain may compromise the performance of this door type. In these situations, open out doors are recommended, which incorporate a rebate behind the door leaf. Personnel doors are available as open-out or open-in, double doors are available open-out only.

The installation

DuraPass double is a precision designed and manufactured product that requires the same attention to detail at installation. **The door is manufactured to a tolerance of $\pm 2\text{mm}$ in width or height.**

It must be installed to a tolerance of $\pm 1\text{mm}$ per metre or less, to ensure the doors operate and functions correctly.

We stipulate the use of a laser level when installing the door frame to ensure the required tolerances are achieved. Failure to do so will impact performance.

If the opening is out of true, packers, wedges and shims should be used to bring the frame to level and square and ensure that the fixings do not distort or twist the frame when tightened.

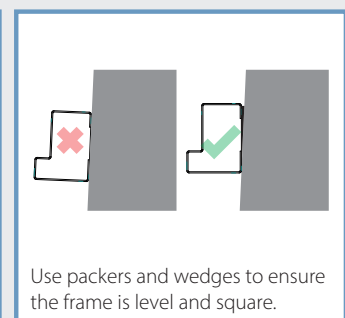
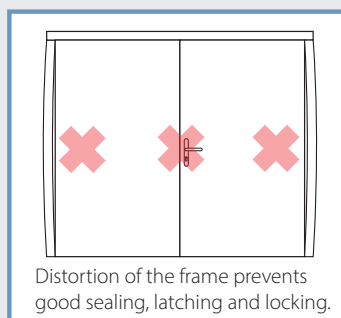

DuraPass Technical Information Standard Colours: White, Black, Anthracite Grey, Goosewing Grey and Golden Oak

DuraPass insulated & uninsulated side hinged double garage door and insulated single personnel door

DIMENSIONS & ORDERING

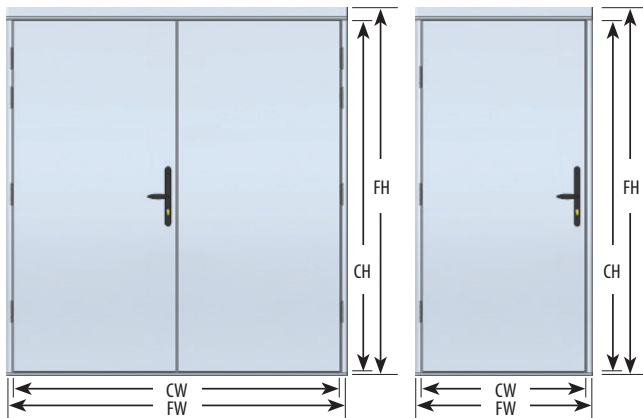

FW Frame width
 CW Clear passage width* = FW - 140mm single leaf & - 170mm double leaf
 FH Frame height
 CH Clear passage height = FH - 72mm For standard 15mm open out low profile threshold
 CH Clear passage height = FH - 80mm For standard open in threshold and double leaf doors
 CH Clear passage height = FH - 87mm For optional 30mm threshold

*Exclude handle protrusion

To order specify:

Ordering size: No fitting clearance allowed. Garage Door Systems recommends allowing 10mm in width and 10mm in height when fitting between brickwork. Example: For a 1000mm x 2100mm structural opening order 990mm x 2090mm. See Garage Door Systems Survey/Order form for full details.

Handing: Single Doors: hinged on the left or right as viewed from the outside.

Leading Leaf: Double Doors: Right hand leading (standard) or Left hand leading as viewed from the outside.

Opening: Outward only - double doors. Outward or inward - single doors, As viewed from the outside.

Threshold: Standard threshold options for single and double leaf doors as details shown right.

If your door is supplied with protective film it must not be exposed to direct sunlight as this can lead to it baking on to the door. If storing doors outside please pay particular attention to this consequence. Protective film must be removed immediately following installation.

EXAMPLE DOOR LEAF SIZES FOR 50:50 AND ASYMMETRIC DOUBLE DOORS

On asymmetric doors the leading leaf width is fixed at 1000mm

****Uninsulated doors are available in made to measure sizes but not available with asymmetric split.**

For door sizes between 1200mm and 1585mm width, please contact Garage Door Systems to discuss design options.

50:50 or asymmetric split doors					
Asymmetric split door over frame size**					
1585mm		1800mm		1900mm	
475	1000	690	1000	790	1000

50:50 split door over frame size													
1585mm		1800mm		1900mm		2000mm		2100mm		2200mm		2300mm	
738	738	845	845	895	895	945	945	995	995	1045	1045	1095	1095

SIZE AVAILABILITY Only insulated doors are available in made to measure sizes

Single Leaf Insulated Doors (open in or open out)
 Min Overframe Width = 790mm Max Overframe Width = 1210mm
 Min Overframe Height = 1785mm Max Overframe Height = 2400mm

Double Leaf Insulated Doors (open out only)
 Min Overframe Width = 1200mm Max Overframe Width = 2300mm
 Min Overframe Height = 1785mm Max Overframe Height = 2400mm

Double Leaf Uninsulated Doors (open out only) Standard sizes only:
 Also available made to measure, as shown in the table above.

Nominal	Over Frame
6'8.5" x 6'3"	2146 x 1971
7'0" x 6'4"	2234 x 1991
7'0" x 6'6"	2234 x 2041
7'0" x 7'0"	2234 x 2196
7'2.5" x 6'3"	2298 x 1971
7'2.5" x 6'6"	2300 x 2041

THRESHOLD INSULATED DOUBLE DOORS

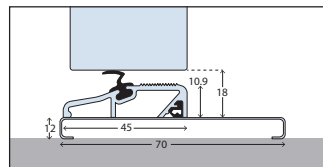

Standard open out ramped threshold

THRESHOLDS SINGLE DOORS

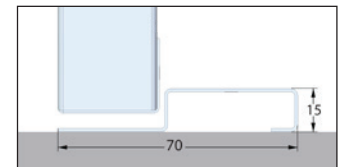

Standard open out 15mm low profile threshold

THRESHOLD UNINSULATED DOUBLE DOORS

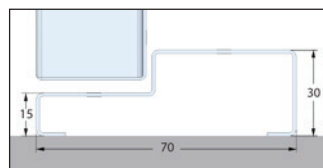

Standard 30mm open out rebated threshold (Optional on insulated doors, must be specified if required)

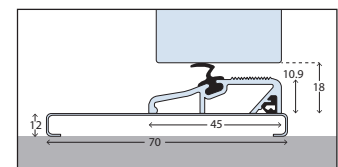

Standard inward opening threshold

FRAME DETAIL

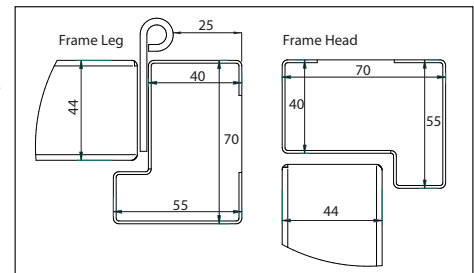

IMPORTANT!

DuraPass door frame and door leaf components are manufactured to a tolerance of ± 2mm

Sizes illustrated are selected examples - all doors are made to measure.

The minimum door leaf width that can be supplied with a stay is 450mm.

Doors are available with left or right leading leaf at no extra cost.

Fitting note: To minimise the ingress of rain run-off between the foot of the door leaf and the door threshold consideration must be given the floor surface to which the door is fitted ensuring that water is able to drain freely away. This particularly important on inward opening single doors - see page 12 for details.



Proudly made in the UK!



From Ballymena to the UK & Ireland
We're proud of our manufacturing capability at our state of the art facility in Ballymena.

We deliver to over 90 specialist distributors throughout the UK and Ireland. Your local Garage Door Systems' Specialist will look after you from initial survey, to colour samples to installation and aftercare.

Visit:
www.garagedoorsystems.co.uk or
www.garagedoorsystems.ie
to find your local distributor.



And fast too...

Our parametric design capability and patents make DuraPass both an exceptional product and one that is available within a few weeks of placing an order.

4-6 week lead-time from our UK factory!



Garage Door Systems Limited,
Wakehurst Ind. Est., Ballymena BT42 3AZ

NI: Tel: 028 2565 5555 Fax: 028 2564 4030

Rol Tel: 1850 510 510 Fax: 028 2564 4030

UK Tel: 0870 242 3 242 Fax: 0800 085 2741

Email: info@garagedoorsystems.co.uk

Web: www.garagedoorsystems.co.uk

Garage Door Systems operates a policy of continuous product development and reserves the right to alter specifications to product design features, product functionality, other product specifications and product manufacture without notification. All specifications are correct at time of publication, errors and omissions excepted. Date 12/22 Issue 1. Colours shown are for guide purposes only and are limited by the printing process.